

Graystone, Phase I Lot 35

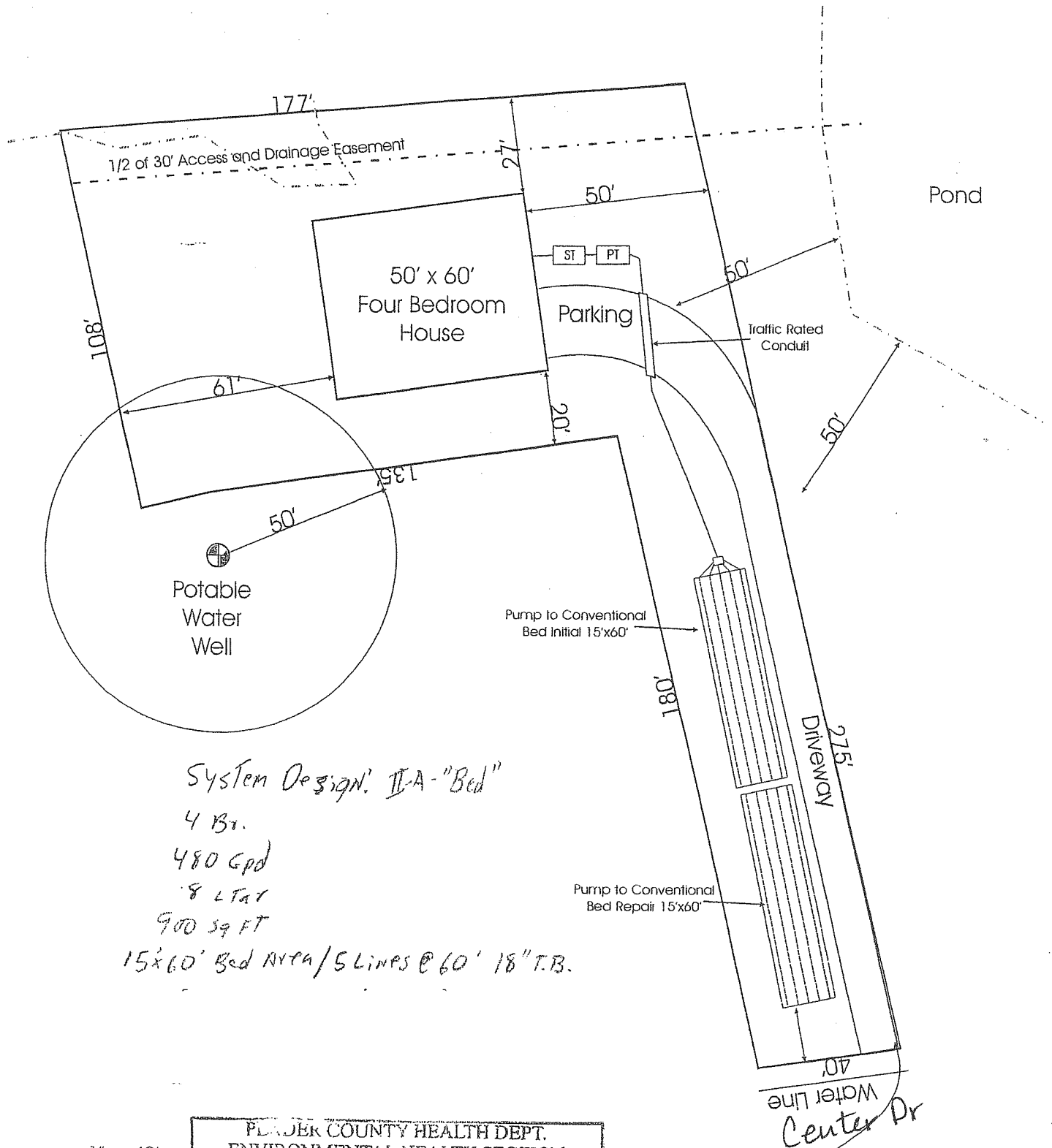

System Design: II-A-"Bed"
 4 Br.
 480 Gpd
 8 LTAT
 900 sq FT
 15'x60' Bed NYTA/5 LINES @ 60' 18" T.B.

1" = 40'
 EFC
 4/10/07

PLASDER COUNTY HEALTH DEPT. ENVIRONMENTAL HEALTH SECTION P.O. BOX 1209 BURGAW, NC 28425	
PERMIT #	102246
PAGE	2 OF 2
SIGNATURE	<i>Clayton</i> 05-15-07
DATE	

No Vertical Cut of Greater than 2'
 for Driveway Entrance Within
 15' of Drallines

Environmental Health PENDER COUNTY, North Carolina

P. O. Box 1209
Burgaw, NC 28425

Environmental Health
910-259-1233

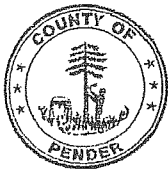

IMPROVEMENT PERMIT SITE

Page 1
#

No Zoning or Building Permit is to be issued with this permit.
See Article 11 NC General Statutes, Chapter 130A-336 through 130A-338

<u>Zoning Determination</u>	<u>Construction Authorization</u>	Permit# : 072431	Fee : 250.00
JP	7/09/07	Issued Date : 07202007	Code Violation:
		Issued By : AB31	GEO PIN # : 32828184230000
		EH - File # : 102246	
		EHS ASSIGNED CC	

Permitted Use / Description of Work

Single family dwelling

Description of Work

Site evaluation for a 50 x 60 SFR (Not to exceed 35' in height)

Applicant: CORNETTE ELLEN
PO BOX 882
HAMPSTEAD NC

Work Phone: 9102702919
Home Phone:
Fax :

Relationship of Applicant to Owner :
REP. FOR APPLIED RESOURCE MGMT PC

Owner : GRAYSTONE OF PENDER LLC
PO BOX 1069
HAMPSTEAD NC

Work Phone:
Home Phone:
Fax :

SITE ADDRESS : CENTER DR
Subdivision : GRAYSTONE
Section /Block : PH 1 Lot: 35 Deed Book/Page:
Township : TOPSAIL Plat Bk. & Page #:

WATER SUPPLY : Private Well SEWER SERVICE Private Septic

Directions to Site:

Lt 35 Graystone Ph 1--Hwy 17 S to Hughes Rd, turn left go to first road on right turn, go to Center Dr. take left go to lots on right on Center Dr.

Requirements

- LOT SIZE - 20,000 SQ FT
- EXISTING WELLS, SPRINGS, OR EXISTING WATER LINES ON PROPERTY - N
- ANY JURISDICTIONAL WETLANDS - N
- IS THE SITE SUBJECT TO APPROVAL BY ANY OTHER PUBLIC AGENCY - N
- STRUCTURE/CONSTRUCTION TYPE - HOUSE
- NUMBER OF BEDROOMS - 4
- NUMBER OF OCCUPANTS - 8
- BASEMENT - N
- GRINDER PUMP FOR LOWER LEVEL PLUMBING - N
- SYSTEM TYPE - II-A "BED"
- LTAR (GPD/FT) - .8
- DAILY DESIGN FLOW (GPD) - 480
- WASTEWATER TYPE - DOMESTIC
- SEPTIC TANK SIZE (GALLONS) - 1,000
- NITRIFICATION FIELD (SQ. FT) - 900
- NUMBER OF LINES - 5
- LENGTH OF LINES (FT) - 60
- TRENCH WIDTH (INCHES) - LINES 3' ON CENTER
- TRENCH DEPTH (INCHES) - 18
- BED SYSTEM SIZE - 15' X 60'

Environmental Health PENDER COUNTY, North Carolina

P. O. Box 1209
Burgaw, NC 28425

Environmental Health
910-259-1233

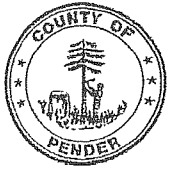

IMPROVEMENT PERMIT SITE

Page # 2

No Zoning or Building Permit is to be issued with this permit.

See Article 11 NC General Statutes, Chapter 130A-336 through 130A-338

		Permit#	:	072431			
		Issued Date	:	07202007	Fee	:	250.00
		Issued By	:	AB31	Code Violation:		
		EH - File #	:	102246	GEO PIN #	:	32828184230000
<u>Zoning Determination</u>	<u>Construction Authorization</u>						
JP	7/09/07	0/00/00		EHS ASSIGNED CC			

TYPE OF WATER SUPPLY - PUBLIC
TYPE OF FACILITY THE PROPOSED SITE IS TO SERVE - 4 BR. DWELLING
DISTANCE FROM ALL WELLS (FT) *NO CASE LESS THAN 50 FT. - 100

No Zoning or Building Permit is to be issued with this permit.
See Article 11 NC General Statutes, Chapter 130A-336 through 130-A-338
This permit is subject to revocation if site plans or intended use changes.

This permit does not constitute a warranty or guarantee and satisfactory performance is not assured by the Pender County Health Department.

The site is subject to approval by other public agencies 1973 (b) (l) (c).

Conditions

Prior to CA issuance: submit final Subdiv. survey map. If gravity flow cannot be maintained, a pump system will be required.

Notes

- Before final zoning, a plat must be approved by the Pender County Planning Department and recorded in the Pender County Registry.
- Check for new tax identification number at final zoning and update permit accordingly.
- Preliminary plat approved by A. Collins and P. Overstreet (Environmental Health) for the purpose of a soil evaluation ONLY.
- 404 wetlands on site and are subject to AEC regulations as applicable.

Improvement Permit: *[Signature]* Issue Date: 07-16-07
 5 Year Improvement Permit: _____ Issue Date: _____
 Improvement Permit, No Expiration Date: _____ Issue Date: _____