

# Graystone, Phase I Lot 4

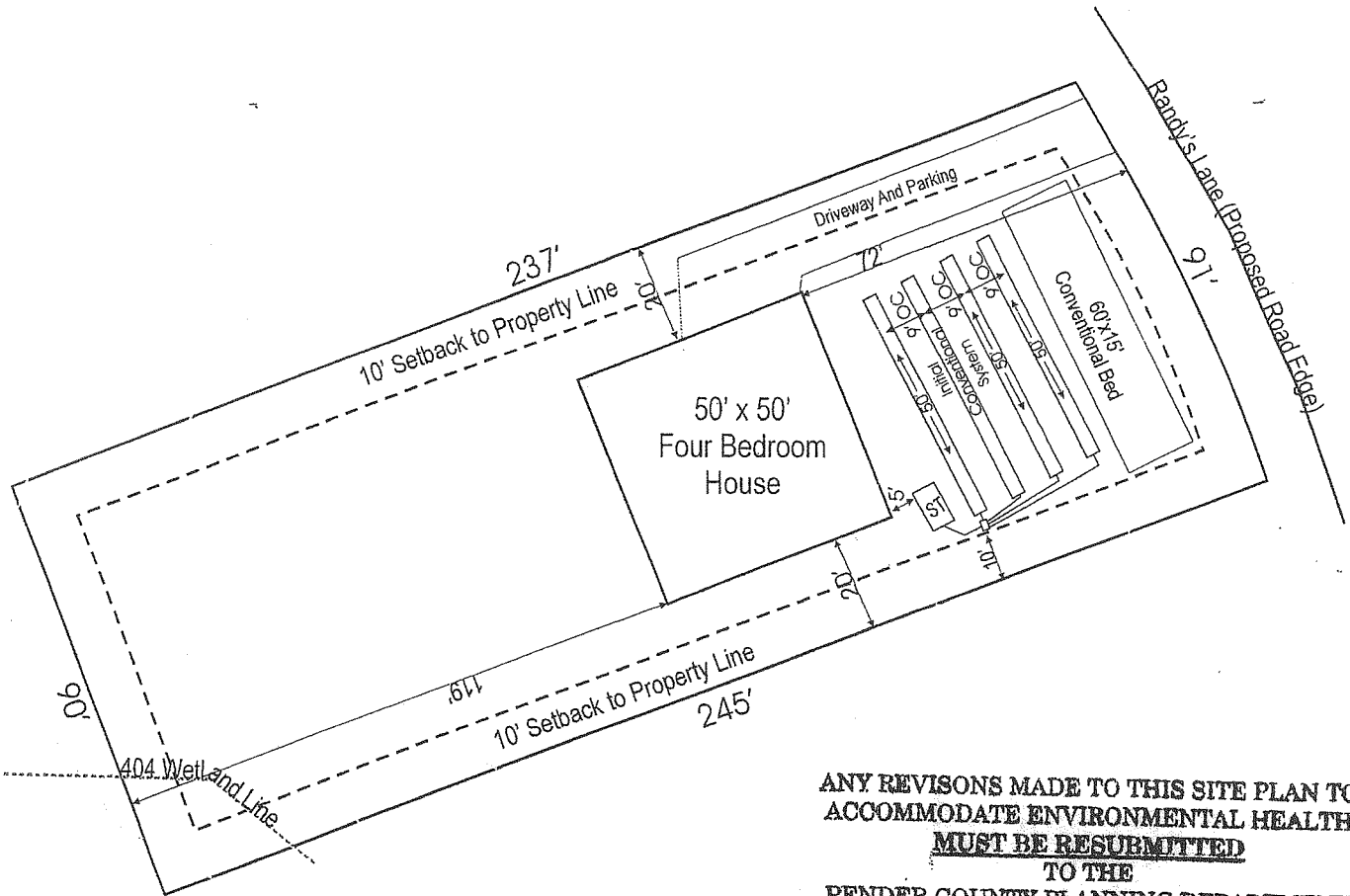

ANY REVISIONS MADE TO THIS SITE PLAN TO  
ACCOMMODATE ENVIRONMENTAL HEALTH  
**MUST BE RESUBMITTED**  
TO THE  
PENDER COUNTY PLANNING DEPARTMENT  
FOR APPROVAL & COMPLIANCE

(Extra Space)

*gg* 7-20-07  
Initials / Date

*0' 48 LS/CA  
45' 3' C/CA  
50' 48'  
8 LATA*

*8/7/07*

72571 (Lot 4)

PENDER COUNTY HEALTH DEPT.  
ENVIRONMENTAL HEALTH SECTION  
P. O. BOX 1299  
BURGLAW, NC 28425  
PERMIT # 102272  
PAGE 2 OF 2  
*Henry A. Jerry* 7/10/07  
SIGNATURE DATE

1" = 40'  
EFC  
7/10/07

Drawn By: *[Signature]* Date: 7/11/07

Permit # 102272

PENDER COUNTY HEALTH DEPARTMENT

Map # \_\_\_\_\_

Page 1 Of 2

P.O. BOX 1209, BURGAW, NC 28425  
PHONE: (910) 259-1233

Record # \_\_\_\_\_

IMPROVEMENT PERMIT

NO BUILDING PERMIT IS TO BE ISSUED WITH THIS PERMIT

Article 11 N.C. General Statues Chapter 130 {GS 130A-336}

THIS PERMIT IS SUBJECT TO REVOCATION IF SITE PLANS OR INTENDED USE CHANGES

Owner/Agent Ellen Cornette Applied Resource Management. P. C. Date \_\_\_\_\_

Address P.O. Box 882 Hampstead NC 28443

Site Location \_\_\_\_\_

Subdivision Gray Stone Lot No. 4 Section/Block One

System Type/Description 2a Conventional system LTAR \_\_\_\_\_ gpd/ft2

Daily Design Flow 480  Domestic Waste Water  Industrial Water

Trench Depth \_\_\_\_\_

Type Facility the Proposed Site is to serve Single Family Dwelling

Water Supply:  Private Well  Community Well  Public  Other

Distance From All Wells 100FT \*\*\*\*\*IN NO SITUATION LESS THAN 50'\*\*\*\*\*

Additional Information Prior to the construction Authorization issuance, the following conditions shall be met. A specific site plan drawn to scale 1 inch =60 ft. or less. Plan must include garage entrance, front or side, with driveway specification. Upon submittal of site plan to office for revision, the proposal shall be stake on lot as site plan proposed. If there are any question please call the office @ 910-259-1233 or 910-270-5000

SEE ATTACHED PAGES \_\_\_\_\_ OF \_\_\_\_\_ FOR SYSTEM LOCATION, ADDITIONAL SPECIFICATIONS AND ANY ADDITIONAL PERMIT CONDITIONS ARE A PART OF THIS IMPROVEMENT PERMIT AND OTHER IMPORTANT INSTALLATION INSTRUCTIONS.)

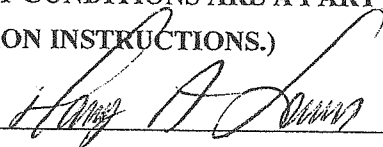
Signed Harry Lewis Rs Bs.  Date September 11, 2007